

ESSEX COUNTY

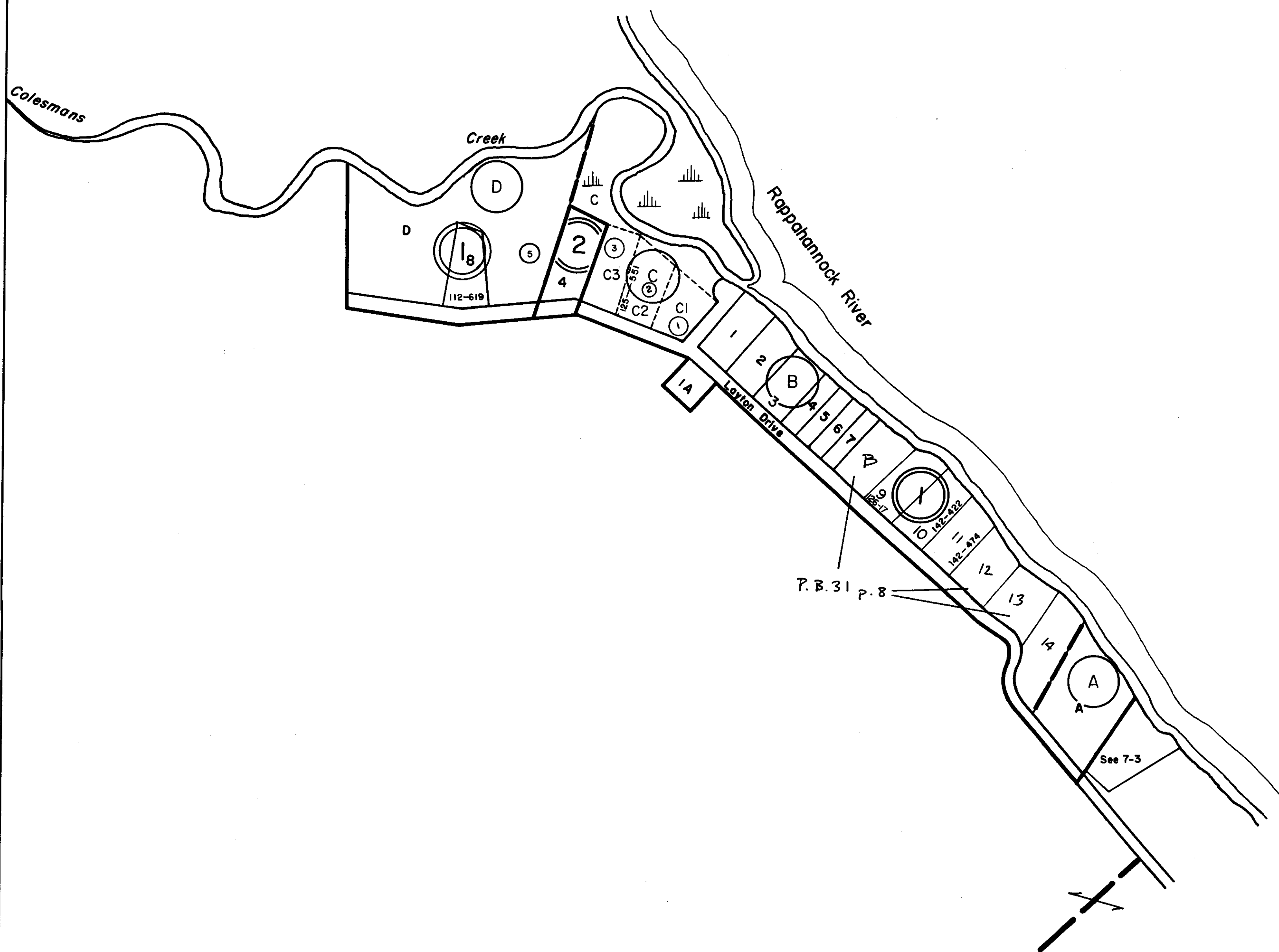

- ① J.H.ALLEN'S FARM SURVEY - RB.7, Pg. 11 & 3.
DB.94, Pg. 478
- ② J.H.ALLEN'S LOTS-COLEMANS CREEK - D.B. 98, Pg. 600, 603

REV. - 65, 1/66, 1/82, 7/95, 12/00
SCALE IN FEET



OCCUPANCIA DISTRICT

SECTION
INSERT 7A

VIRGINIA STATE DEPARTMENT OF TAXATION, DIVISION OF REAL ESTATE APPRAISAL AND MAPPING